

WiFi Monitoring Module Installation Guide

Step 1. Connect the CubeWiFi module.

Plug the CubeWiFi into the WiFi/GPRS port on the inverter.

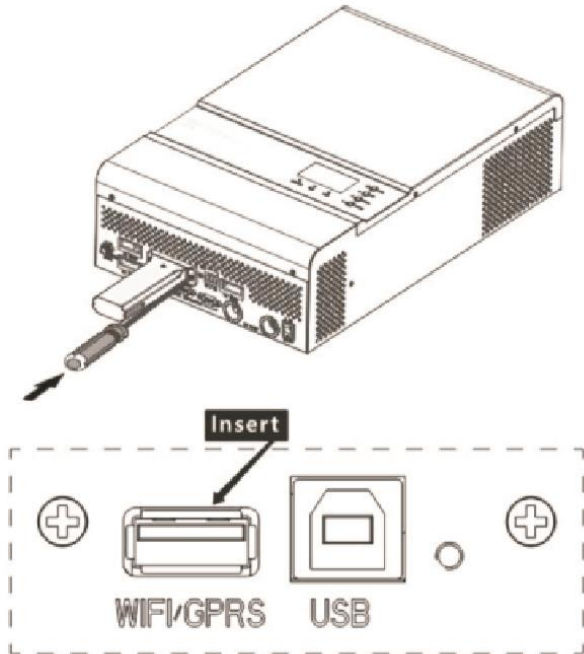

Turn on the inverter, red flashing LED indicates a normal communication between the inverter and CubeWiFi.

Step 2. Download PVbutler APP.

Connect your cellphone to your own WLAN WiFi, scan the QR code below to download the PVguarder or go to the website: <http://server.PVbutler.com> to download and install it.



Android & iOS

Step 3. Registration and Adding Data logger

3.1 Register your account in the "PVbutler" APP.

Open the PVbutler APP, click "Register" on the login page. Select your country and city, then click "Next" to enter the next page.

Note: If you select a wrong country and city, the system time may be wrong. Fill out the required information, then click "Next", it will guide you to the "Add datalogger" page.

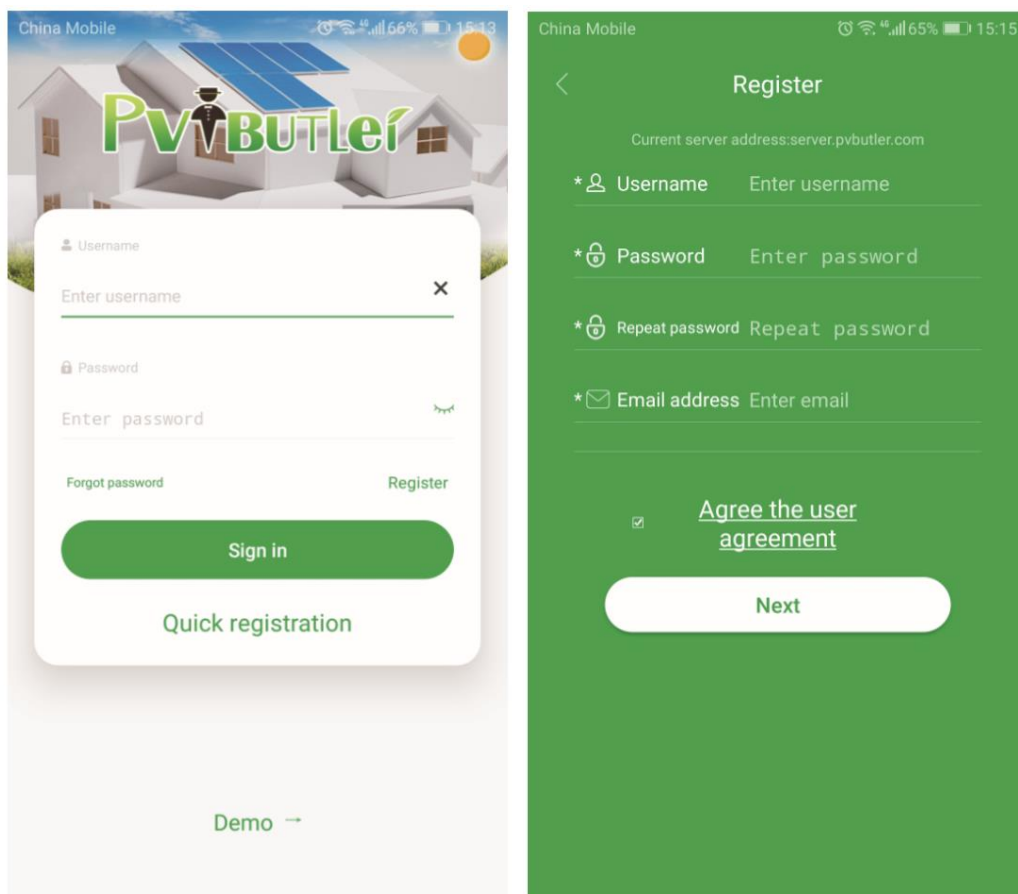

3.2 Add your solar inverter (Cube Wifi module) into your "PVbutler" account.

On the "Add datalogger" page, scan or input the CubeWifi module serial number(SN:IQB*****) into the "Datalog SN" box and input the check code(CC:****) into the "Datalogger Checkdoe" box, then click "Resigter" , it will direct you to the "Set CubeWiFi" page.

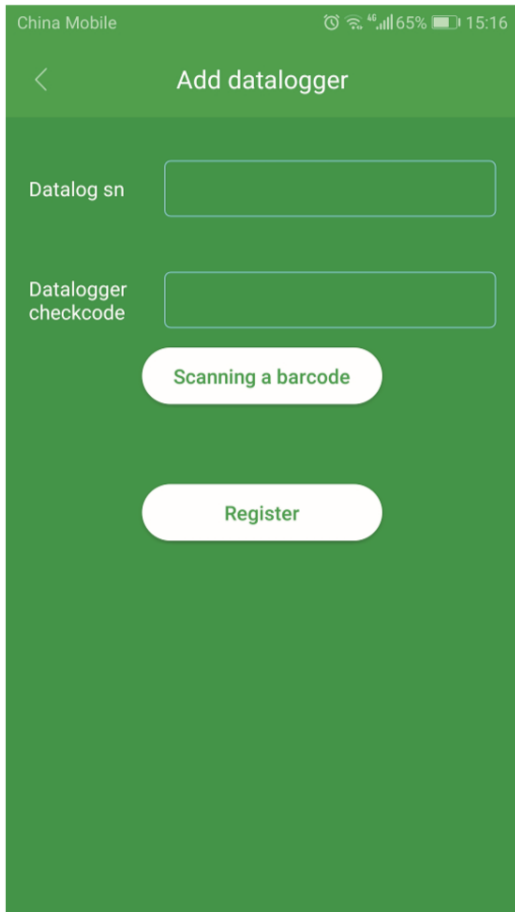

3.3 Connect your solar inverter to your local WiFi Network.

Fill in your local WiFi network and password, then click "Configuration". After successful configuration, a note will pop up "Configured successfully", then it will move to the "My Plant" page.

Note: There are 3 LEDs on the CubeWifi module; only the blue LED flashing indicates the successful connection to the router and PVbutler server.

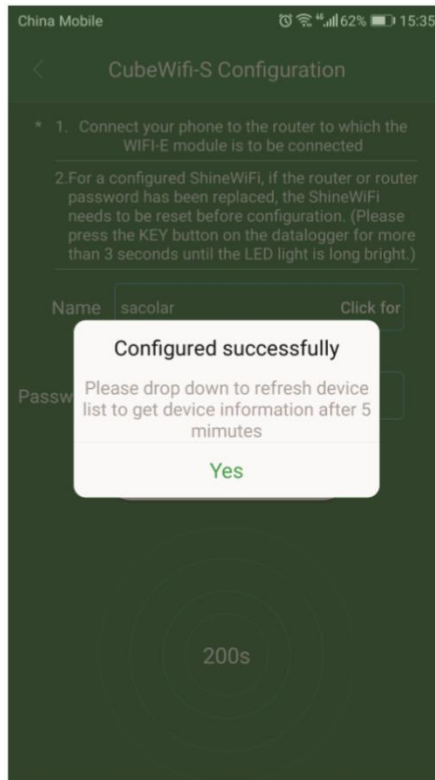
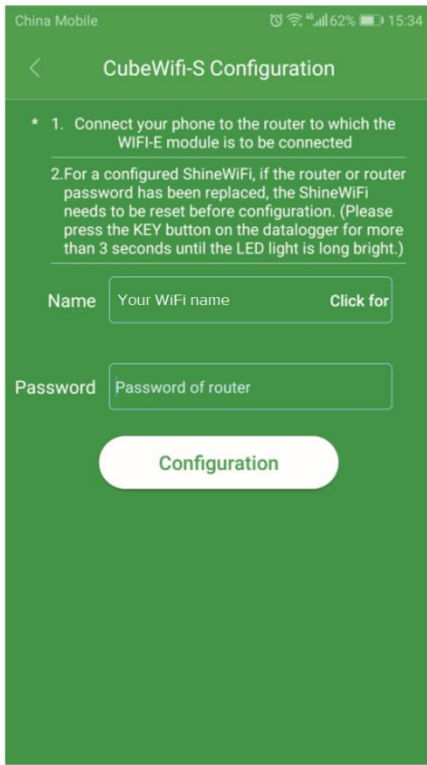

3.4 Start monitoring your solar system:

After a successful configuration, it will move to the "My plant" page, select the inverter in the device list to check the inverter update information.

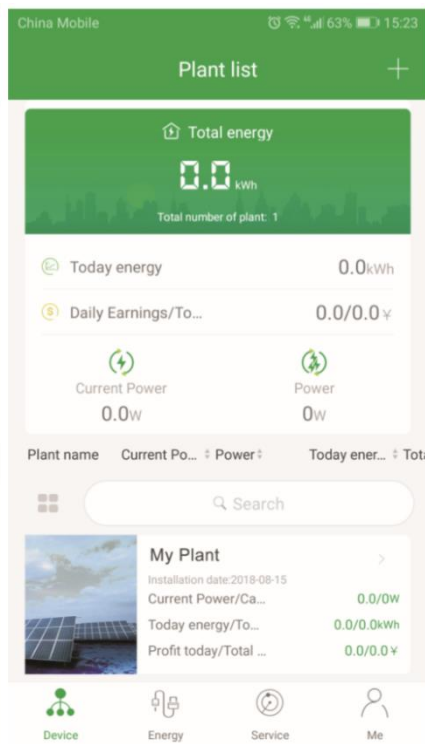
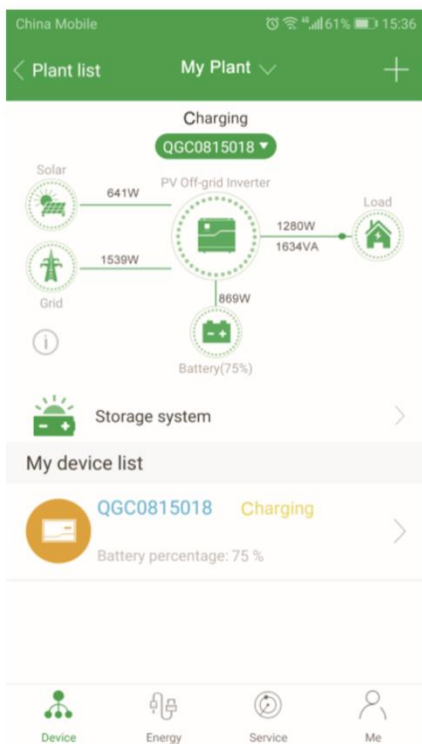

3.5 Add/check/configure/delete your solar system.

Click the "+" sign on the right top side of the "My Plant" page. There are three options.

1) "Add datalogger" is for adding a new CubeWiFi module to this account.

2) "Check datalogger" is to check the CubeWiFi in this account.

After choosing "Check datalogger", long press the serial number, it will show a dialog with 3 options.

a) "Change device alias" is used to change the name of the device

b) "Configure datalogger" is used for configuring the connection of the CubeWiFi module to the router.

c) "Delete datalogger" is used to remove the CubeWiFi module from this account.

3) "Add plant" is used to add a new plant page to this account.

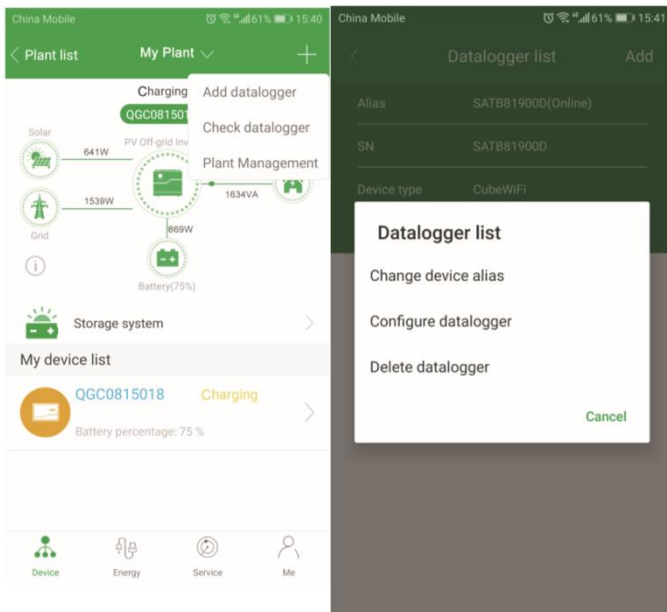

Step 4. Reconfigure CubeWiFi

When you change your home router password or change to a new router, you need to reconfigure the CubeWiFi.

Press the KEY button for 6 sec, until all three LEDs long light up, then login to your PVbutler account, click the "+" on the right top of this page, choose "Check datalogger" , long press the datalogger serial number to reconfigure.

CubeWiFi State

LED State	Indication
All 3 LEDs off	CubeWiFi not connected with the inverter USB port.
Red LED flashes	CubeWiFi and inverter communication is OK
Green LED flashes	CubeWiFi, inverter and router communication is OK
Blue LED flashes	CubeWiFi, inverter, router and server communication is OK

CubeWiFi KEY Button Description

Operation	Description
When CubeWiFi is powered on, press the KEY button.LED will change from flash to constant on.	CubeWiFi will enter to AP mode. AP mode is a debug mode, only allowed for the professional.
When CubeWiFi in AP mode, press The KEY button. LED will change from constant on to flash.	Quit AP mode.
Long press the KEY button for More than 6 sec. All LEDs will get constant on.	Reset to factory default settings.

Troubleshooting

LED State	Indicate	Troubleshooting
All 3 LEDs are dark.	CubeWiFi can't find the inverter via USB port.	1 Try to reconnect. 2: Try to restart the inverter
After configuration, only red led flashes.	CubeWiFi can't connect to the homer router.	1 Check router information a) Router name should consist of English letters and numbers, it does not support special symbols b) For safety reason, please use encrypted wireless network c) It does not support public network that uses the secondary authentication. 2. Check if you filled in the correct name and password of the home router when configuring it
After configuration, Only Green LED flashes.	CubeWiFi already connected to the home router, but not connected to PVbutler server	1. Check if the home router is connected to the internet 2. Check if the router firewall allows to select port 5279 and 5280
After configuration, only Blue LED flashes	CubeWiFi communicates normally with the inverter, home router, and PVbutler server.	Normal.

Red LED constant on.	Error.	Need replacement.
Green LED constant on.	CubeWiFi in switching mode.	No response if you press KEY button during this period.
Blue LED constant on.	CubeWiFi in AP mode.	Debug mode, short press the KEY button to quit.